

YC SERIES

SINGLE PHASE HEAVY-DUTY CAPACITOR START MOTOR

YC series heavy-duty single-phase motors are suitable for small size machine tools and water pumps, especially for family workshops where only single-phase power supply is available. Motors of this series are integrated with up-to-date design, manufacture with the best quality materials, possess the features of pleasant-looking appearance and meet the IEC standard.

Operating Conditions

Ambient temperature: $-15^{\circ}\text{C} < \theta < 40^{\circ}\text{C}$
Above sea level: not exceed 1000meters
Rated voltage: 220V
Rated frequency: 50Hz/60Hz
Duty/Rating: Continuous(running)
Insulation class: Class B/F
Protection class: IP44/IP54
Cooling method: IC0141

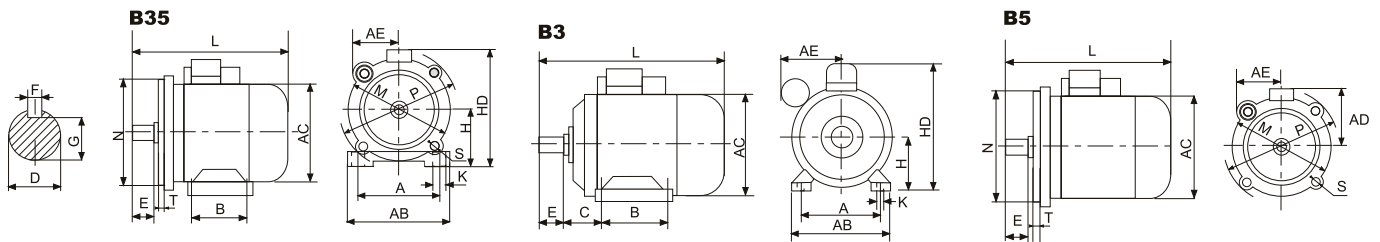
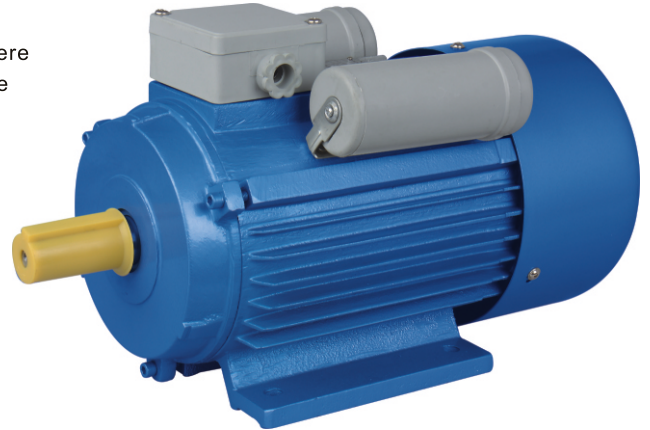

Installation Dimension

in mm

TYPE	Installation Size															Overall Dimension					
	A	B	C	D	E	F	G	H	K	M	N	P	R	S	T	AB	AC	AE	AD	HD	L
80	125	100	50	19	40	6	15.5	80	10	165	130	200	0	12	3.5	160	165	110	120	200	310
90S	140	100	56	24	50	8	20	90	10	165	130	200	0	12	3.5	180	185	120	140	240	355
90L	140	125	56	24	50	8	20	90	10	165	130	200	0	12	3.5	180	185	120	140	240	385
100L	160	140	63	28	60	8	24	100	12	215	180	250	0	15	4.0	205	220	130	145	260	415
112M	190	140	70	28	60	8	24	112	12	215	180	250	0	15	4.0	245	250	140	160	300	448
132S	216	140	89	38	80	10	33	132	12	265	230	300	0	15	4.0	280	262	150	210	350	470
132M	216	178	89	38	80	10	33	132	12	265	230	300	0	15	4.0	280	262	150	210	350	553

YC SERIES TECHNICAL DATA

TYPE	Output		Voltage (V)	Current (A)	Speed (r/min)	Eff (%)	Power Factor	Start torque Rated torque	Start current Rated current	Max. torque Rated torque
	HP	KW								
220V 50Hz Synchronous Speed 3000 r/min (2 Poles)										
YC80A-2	0.5	0.37	220	3.5	2880	62	0.73	2.8	6.5	1.8
YC80B-2	0.75	0.55	220	5.3	2880	65	0.73	2.8	6.5	1.8
YC80C-2	1	0.75	220	6.7	2880	68	0.75	2.8	6.5	1.8
YC90S-2	1.5	1.1	220	9.1	2880	71	0.77	2.4	7	1.8
YC90L-2	2	1.5	220	11.4	2900	72	0.78	2.4	7	1.8
YC100L-2	3	2.2	220	16.5	2900	74	0.79	2.1	7	1.8
YC112M1-2	4	3	220	21.4	2900	76	0.84	2.2	7	1.8
YC112M2-2	5	3.7	220	24.8	2900	79	0.86	2.2	7	1.8
220V 50Hz Synchronous Speed 1500 r/min (4 Poles)										
YC80A-4	0.33	0.25	220	3.4	1450	56	0.60	2.8	6	1.8
YC80B-4	0.5	0.37	220	4.5	1450	60	0.62	2.8	6	1.8
YC80C-4	0.75	0.55	220	6.0	1450	64	0.65	2.8	6	1.8
YC90S-4	1	0.75	220	7.7	1450	67	0.66	2.4	6.5	1.8
YC90L-4	1.5	1.1	220	10.4	1450	70	0.68	2.4	6.5	1.8
YC100L-4	2	1.5	220	13.5	1450	72	0.70	2.4	6.5	1.8
YC112M-4	3	2.2	220	18.5	1450	72	0.72	2.4	6.5	1.8
YC132SA-4	4	3	220	22.4	1450	74	0.73	2.1	6.5	1.8
YC132SB-4	5	3.7	220	26.0	1450	75	0.74	2.1	6.5	1.8
YC132M-4	7.5	5.0	220	30.5	1450	81	0.95	2.1	6.5	1.8